



OMC LOWER UNIT COMPLETE GEAR SET & CLUTCH DOG
Part No. 444-10
14:26 ratio with big reverse gear



OMC COMPLETE GEAR SET
Part No. 444-12
Fits: 60 degree small foot 1995 2003 and V4XFLOW 1978-98, Ratio 13..26

Photo not available

OMC GEAR SET
Part No. 444-13
Fits: 2Cyl. 25-35hp



OMC THRUST WASHER
Part No. 18-4230
Replaces 320305

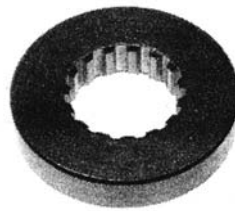

OMC PROP SPACER
Part No. 18-4231
Replaces: 320570

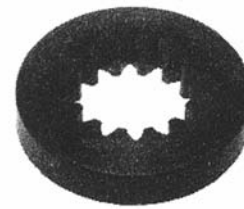

OMC PROP SPACER
Part No. 18-4232
Replaces: 323943



OMC STAINLESS STEEL COTTER PINS

| Part No. | O.E. No. | Dimensions |
|----------|----------|---------------|
| 18-3740 | 302804 | 3/32" X 1" |
| 18-3741 | 309955 | 1/8" X 1 3/4" |
| 18-3742 | 314502 | 1/8" X 1 1/4" |
| 18-3743 | 320785 | 1/8" X 3/4" |
| 18-3744 | 552906 | 3/32" X 3/4" |

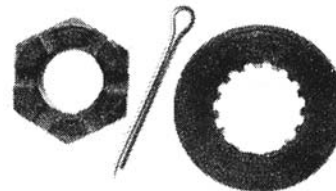

OMC PROP NUT KIT 18-3715

| Part No. | O.E. No. | Dimensions |
|-----------|----------|-----------------|
| 18-3708-1 | 398042 | Prop/Nut Keeper |
| 18-3741 | 309955 | Cotter Pin |
| 18-4231 | 320570 | Prop Spacer |

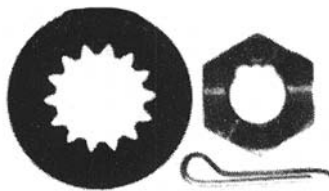

OMC PROP NUT KIT 18-3717 Replaces: 175268

| Part No. | O.E. No. | Dimensions |
|----------|----------|-------------|
| 18-3707 | 319891 | Prop Nut |
| 18-3743 | 320785 | Cotter Pin |
| 18-4232 | 323943 | Prop Spacer |

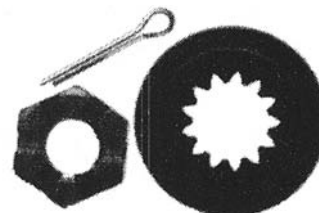

OMC PROP NUT KIT 18-3716

| Part No. | O.E. No. | Dimensions |
|----------|----------|-------------|
| 18-3705 | 314503 | Prop Nut |
| 18-3742 | 314502 | Cotter Pin |
| 18-4228 | 315810 | Prop Spacer |



CHRYSLER/FORCE

| HP | Year | Part No. |
|-------------|------------|-----------|
| 6/7.5 | 1978-Up | 18-2637 |
| 9.9/15 | 1997-Prior | 18-2638 |
| 9.9/15 | 1998 | 18-2697-1 |
| 20/25 | 1972-78 | 18-2639 |
| 25 | 1989 | 18-2636 |
| 25 | 1996-97 | 18-2624 |
| 25 | 1998 | 18-2629 |
| 35 | 1986-91 | 18-2639 |
| 35 B | 1989-91 | 18-2636 |
| 40 | 1992-94 | 18-2636 |
| 50 | 1984-94 | 18-2636 |
| 55 | 1978-82 | 18-2630 |
| 55 | 1983 | 18-2633 |
| 60 | 1984-Prior | 18-2630 |
| 60 | 1985 | 18-2633 |
| 65 | All | 18-2633 |
| 70 | 1991-95 | 18-2635 |
| 75 | 1980-83 | 18-2632 |
| 75 | 1996-98 | 18-2635 |
| 75 | 1999 | 18-2626 |
| 85 | 1980-89 | 18-2632 |
| 85 L Drive | 1989 | 18-2640 |
| 90 | 1983 | 18-2632 |
| 90 | 1990-94 | 18-2640 |
| 90 | 1995-99 | 18-2626 |
| 90 L Drive | 1990-91 | 18-2640 |
| 105 | 1979-83 | 18-2632 |
| 120 | 1990-94 | 18-2640 |
| 120 | 1995-99 | 18-2626 |
| 125 | 1983-89 | 18-2632 |
| 125 D & E | 1989 | 18-2640 |
| 125 L Drive | 1989 | 18-2640 |
| 150 | 1989-94 | 18-2640 |

HONDA

| HP | Serial No. | Part No. |
|------------------|------------|-----------|
| BF 9.9/BF 15 | - | 18-8363 |
| BF 20 | - | 18-8364 |
| BF35/45 AM | - | 18-8362-1 |
| BF 40/50 A/AW/AX | - | 18-8362-1 |
| BF 75 BF 90 | - | 18-8366 |
| BF 115/ BF 130 | - | 18-8365 |

MERCURY/MARINER

| HP | Serial No. | Part No. |
|-----------------------|-----------------|-----------|
| 4 (1 Cyl) | 5595532-A809600 | 18-2628 |
| 4 (1 Cyl) | 5595532-A809600 | 18-2628 |
| 4.5 (1 Cyl) | | 18-2628 |
| 6 | | 18-2697-1 |
| 7.5 | | 18-2628 |
| 8 | | 18-2697-1 |
| 8 Bodensee (4 Cyl) | | 18-2697-1 |
| 9.8 | | 18-2628 |
| 9.9 | | 18-2697-1 |
| 9.9 4 Cyl non-bigfoot | | 18-2697-1 |
| 9.9 (4 Cyl) Bigfoot | | 18-2624 |
| Seapro/XR10 | | 18-2697-1 |
| 15 | | 18-2697-1 |
| 15 4 Cyl Non-Bigfoot | | 18-2697-1 |
| 15 4 Cyl Bigfoot | | 18-2624 |
| Magnum | | 18-2624 |
| Marathon 15XD | | 18-2624 |

MERCURY/MARINER

| HP | Serial No. | Part No. |
|-----------------------|-----------------|-----------|
| Super 15 | | 18-2624 |
| 18 | 5837437-6443972 | 18-2629 |
| 18 | 6443973&Up | 18-2624 |
| 20 | 4709593-6443972 | 18-2627 |
| 20 | 6443973&Up | 18-2624 |
| 25 | 5705532-6443972 | 18-2629 |
| 25 | 6443973&Up | 18-2624 |
| 25 Lightning 3 Cyl | | 18-2624 |
| 30 4 strk. 3 Cyl | | 18-2626 |
| 35 | | 18-2654 |
| 40 (2 Cyl) | | 18-2654 |
| 40 (4 Cyl) | | 18-2654 |
| 40 4 strk. 3 Cyl | | 18-2626 |
| 45 | | 18-2654 |
| 50 (4 Cyl) | | 18-2654 |
| 50 (3 Cyl) | 6428681-d000749 | 18-2654 |
| 50 (3 Cyl) | D000750-g589999 | 18-2635 |
| 50 4 Strk. 4 Cyl Big | g760300&Up | 18-2626 |
| 50 4 Strk. Bigfoot | g231123&Up | 18-2626 |
| 50 4 Strk Non Bigfoot | | 18-2635 |
| 55 (3 Cyl) | | 18-2635 |
| 60 (3 Cyl) | | 18-2654 |
| 60 3 Cyl Non Bigfoot | | 18-2635 |
| 60 (3 Cyl) Bigfoot | | 18-2626 |
| 60 4 Strk. Bigfoot | | 18-2626 |
| 60 4 Strk NonBigfoot | | 18-2635 |
| 60 Seapro/Marathon | | 18-2626 |
| 60 Big Foot 3 Cyl | | 18-2626 |
| 70 | 4571652-A996141 | 18-2654 |
| 70 | A996142&Up | 18-2626 |
| 75 (4 Cyl) | | 18-2653 |
| 75 (3 Cyl) | | 18-2626 |
| 75 (4 Stroke) | | 18-2626 |
| 80 (4 Cyl) | | 18-2653 |
| 80 (3 Cyl) | | 18-2626 |
| 90 (6 Cyl) | | 18-2653 |
| 90 (3 Cyl) | | 18-2626 |
| 90 (4 Stroke) | | 18-2626 |
| 100 (4 Cyl) | | 18-2626 |
| 115 (6 Cyl) | | 18-2653 |
| 115 (4 Cyl) | | 18-2626 |
| 115EFI(4 Stroke) | | 18-2626 |
| 125 (4 Cyl) | | 18-2626 |
| V-135 | | 18-2655 |
| V-135 DFI | | 18-2655 |
| 140 (6 Cyl) | | 18-2653 |
| V-150 | | 18-2653 |
| V-150 (carb) | | 18-2655 |
| V-150 XR4,XR6, | | 18-2655 |
| Mag II, Mag III | | 18-2655 |
| V-150 EFI | | 18-2655 |
| V-150 DFI | | 18-2655 |
| V-175 | | 18-2653 |
| V-175 (carb) | | 18-2655 |
| V-175 XRI (EFI) | | 18-2655 |
| V-200 | | 18-2653 |
| V-200 (carb) | | 18-2655 |
| V-200 XRI(EFI) | | 18-2655 |
| V-200 DFI (3.0L) | | 18-2642 |
| V-220 | | 18-2655 |
| V-225 | 5628028&Up | 18-2653 |
| V-225 | D280813&Up | 18-2646-1 |



MERCURY/MARINER

| HP | Serial No. | Part No. |
|-------------------------|------------|----------|
| V-225/225 DFI | | 18-2642 |
| V-250 (Japanese Models) | | 18-2642 |
| 20C | | 18-2785 |
| 25C | | 18-2785 |
| 30A | | 18-2785 |
| W48 | | 18-2787 |
| 55/W55 | | 18-2787 |
| 60 | | 18-2787 |

OMC

| HP | Year | Part No. |
|---------------------|---------|----------|
| 5.5 | 1955-97 | 18-2679 |
| 9.9/15 | 1974-Up | 18-2656 |
| 20 | 1985-Up | 18-2658 |
| 25 | 1979-82 | 18-2685 |
| 25 | 1984 | 18-2657 |
| 25 | 1985-Up | 18-2658 |
| 25 | 1990-95 | 18-2694 |
| 25 (Comm) | 1985-Up | 18-2657 |
| 28 | 1985-98 | 18-2657 |
| 30 | 1976-95 | 18-2658 |
| 35 | 1977-92 | 18-2658 |
| 40 | 1976-88 | 18-2659 |
| 40 | 1989-Up | 18-2694 |
| 48 | 1976-88 | 18-2659 |
| 48 | 1989-96 | 18-2694 |
| 50 | 1976-88 | 18-2659 |
| 50 | 1989-Up | 18-2694 |
| 50 (3 Cyl) | 1995-Up | 18-2660 |
| 55 | 1976-88 | 18-2659 |
| 60 (2 Cyl) | 1976-88 | 18-2659 |
| 60 (3 Cyl) | 1978-Up | 18-2660 |
| 65 | 1978-Up | 18-2660 |
| 70 | 1978-Up | 18-2660 |
| 75 | 1978-91 | 18-2660 |
| 75 (Small Gearcase) | 1976-88 | 18-2659 |
| V-4 | 1978-84 | 18-2623 |
| 85 (V-4) | 1973-83 | 18-2692 |
| 85 | 1991-95 | 18-2623 |
| 88 | 1985-Up | 18-2623 |
| 90 (V-4) | 1973-83 | 18-2692 |
| 90 | 1985-Up | 18-2623 |
| 100 (V-4) | 1973-83 | 18-2692 |
| 100 (Comm) | 1984-90 | 18-2623 |
| 100 (Comm) | 1991-95 | 18-2623 |
| 100 | 1991-92 | 18-2623 |
| 110 (V-4) | 1973-83 | 18-2692 |
| 110 | 1985-89 | 18-2623 |
| 115 (V-4) | 1973-83 | 18-2692 |
| 115 | 1985-Up | 18-2623 |
| 120 | 1985 | 18-2623 |
| 120 | 1986-92 | 18-2623 |
| 120 | 1993 | 18-2623 |
| 125 | 1991-92 | 18-2623 |
| 125 | 1993 | 18-2623 |
| 125 (Comm) | 1991-93 | 18-2623 |
| 135 (V-4) | 1973-83 | 18-2692 |
| 140 (V-4) | 1973-83 | 18-2692 |
| 140 | 1985 | 18-2623 |
| 140 | 1986-92 | 18-2623 |
| 140 | 1992-93 | 18-2623 |
| 140 | 1992-95 | 18-2623 |

OMC

| HP | Year | Part No. |
|-------------------------|---------|----------|
| 150 (V-6) | 1978-86 | 18-2623 |
| 150 | 1991 | 18-2623 |
| 150 | 1991-95 | 18-2623 |
| 155 (Comm) | 1984-90 | 18-2623 |
| 155 (Comm) | 1991-93 | 18-2623 |
| 175 (V-6) | 1977-86 | 18-2623 |
| 175 | 1991 | 18-2623 |
| 175 | 1992 | 18-2623 |
| 175 | 1991-95 | 18-2623 |
| 185 | 1991-93 | 18-2623 |
| 200 (V-6) | 1976-86 | 18-2623 |
| 200 | 1991-95 | 18-2623 |
| 225 | 1991-95 | 18-2623 |
| 235 (V-6) | 1977-86 | 18-2623 |
| V-8 | 1985-91 | 18-2623 |
| 250 (V-8) | 1991-95 | 18-2623 |
| 300 (V-8) OMC Sea Drive | 1991-95 | 18-2623 |
| 1.6L | 1985-90 | 18-2623 |
| 1.8L | 1987 | 18-2623 |
| 2.0L | 1988-90 | 18-2623 |
| 2.5L | 1984-85 | 18-2623 |
| 2.6L | 1984-86 | 18-2623 |
| 2.7L | 1987 | 18-2623 |
| 3.0L | 1988-90 | 18-2623 |
| 3.6L | 1987 | 18-2623 |
| 4.0L | 1989-90 | 18-2623 |

SUZUKI

| HP | Year | Part No. |
|----------|---------|----------|
| DF90/115 | All | 18-8373 |
| DF140 | All | 18-8374 |
| DT25C | 1989-98 | 18-8341 |
| DT30C | 1988-97 | 18-8341 |
| DT40C | 1984-98 | 18-8337 |
| DT55 | 1985-97 | 18-8339 |
| DT65 | 1985-97 | 18-8339 |
| DT75 | 1985-97 | 18-8340 |
| DT85 | 1985-98 | 18-8340 |
| DT90 | 1989-97 | 18-8336 |
| DT100 | 1989-98 | 18-8336 |

YAMAHA

| HP | Year | Part No. |
|------|---------|-----------|
| 25 | 1984-85 | 18-2785 |
| 25 | 1997-02 | 18-2789 |
| C25 | 1990-91 | 18-2785 |
| CV25 | 1991 | 18-2785 |
| 30 | 1984-85 | 18-2785 |
| 30 | 1985-86 | 18-2785 |
| 30 | 1987-02 | 18-2789 |
| C30 | 1991 | 18-2785 |
| CV30 | 1989 | 18-2794-1 |
| 40 | 1984-94 | 18-2792 |
| 50 | 1984-94 | 18-2792 |
| P50 | 1987-94 | 18-2792 |
| C55 | 1991 | 18-2787 |
| CV55 | 1989 | 18-2787 |
| P60 | 1984-91 | 18-2788 |
| 70 | 1984-91 | 18-2788 |
| C85 | 1989-91 | 18-2798 |
| 90 | 1984-91 | 18-2794-1 |



YAMAHA

| HP | Year | Part No. |
|-----------------|---------|-----------|
| I15 | 1986-02 | 18-2794-1 |
| C115 | 1991-00 | 18-2794-1 |
| P115 | 1993-96 | 18-2794-1 |
| S115 | 1996-98 | 18-2794-1 |
| 130(6N7)(6L1) | 1988-02 | 18-2794-1 |
| L130(6N4)(6L6) | 1988-99 | 18-2794-1 |
| S130 | 1996-98 | 18-2794-1 |
| 150(6R2)(6G4) | 1984-02 | 18-2794-1 |
| C150 | 1996-99 | 18-2794-1 |
| L150 (6R0)(6K0) | 1984-99 | 18-2794-1 |
| P150 | 1986-99 | 18-2794-1 |
| PX150 | 1999 | 18-2794-1 |
| S150 | 1994-99 | 18-2794-1 |
| SX150 | 1999-04 | 18-2794-1 |
| V150 | 2001-02 | 18-2794-1 |
| VX150 | 2000-02 | 18-2794-1 |
| VZ150 | 2001-02 | 18-2794-1 |
| Z150 | 2000-02 | 18-2794-1 |
| 175 | 1984-00 | 18-2794-1 |
| 175(6R3)(6G5) | 1985-94 | 18-2794-1 |
| P175 | 1994-99 | 18-2794-1 |
| S175 | 1999 | 18-2794-1 |
| VZ175 | 2001-02 | 18-2794-1 |
| Z175 | 2001-02 | 18-2794-1 |
| 200 | 1984-99 | 18-2794-1 |
| P200 | 1991-00 | 18-2794-1 |
| L200 | 1984-99 | 18-2794-1 |
| LX200 | 1999-02 | 18-2794-1 |
| VZ200 | 2001-02 | 18-2794-1 |
| V6 Special | 1984-86 | 18-2794-1 |
| V6 Excel | 1987-89 | 18-2794-1 |
| 225 | 1990-97 | 18-2794-1 |
| 225/L225 | 1994-96 | 18-2799 |
| 250/L250 | 1990-96 | 18-2799 |

Tilt Tube Tools



TILT TUBE REAMERS

Part No. TTR375

3/8" Shank Dia.

Specialy ground OD to accommodate most Tilt Tubes. Made of high speed tool steel. The reamer assures a round hole and eliminates the need for brushes that just don't last.



TTR1 (3/8)



TTR1 (1/2)

TILT TUBE REMOVER

Part No. TTR1 (3/8)

Part No. TTR1 (1/2)

Fits Evinrude, Johnson, Mercury & Chrysler. Save over 75% of the time normally required in removing tilt tubes. High tensile strength 1/2-13 threaded rod. Hardened flange nut, extra threads. 15" long 7/8" socket to accommodate the threaded rod as you turn flange nut down the threads. 1 5/8" ID slip tube which allows the tilt tube and one nut to enter with ease.

STAINLESS STEEL



| Tilt Tubes | Tube Thickness | Tube Length | Short Threaded End | Long Threaded End | Thread Size |
|------------|----------------|-------------|--------------------|-------------------|-------------|
| 986-100 | 7/8" | 12" | 1-5/8" | 2-3/4" | 7/8" x 14 |
| 986-105 | 7/8" | 12" | 1-3/4" | 1-3/4" | 7/8" x 14 |
| 986-110 | 7/8" | 12 5/8" | 3/4" with nut | 2" | 7/8" x 14 |
| 986-115 | 7/8" | 13 1/4" | 1-1/4" | 2-1/4" | 7/8" x 14 |
| 986-150 | 1" | 11 3/4" | 1" | 1-1/2" | 7/8" x 14 |
| 986-155 | 1" | 11 3/4" | 1" with Nut | 1-3/8" | 7/8" x 14 |
| 986-160 | 1" | 12 1/8" | 5/8" | 1 3/8" | 7/8" x 14 |
| 986-165 | 1" | 12 1/8" | 5/8", 1" dia. | 1-1/2", 7/8" dia | - |



Tilt Nut



Washer

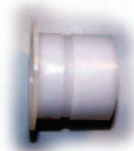

Bushing

| Tilt Tube Bushings | Inside Diameter | Length |
|--------------------|-----------------|--------|
| 986-200 | 7/8" | 1" |
| 986-205 | 1" | 1" |
| 986-210 | 1" | 1-1/2" |
| Washers | | |
| 986-300 | 7/8" | |
| 986-305 | 1" | |
| Nuts | | |
| 986-400 | 7/8" x 14" | Nyloc |
| 986-405 | 7/8" x 14" | Jam |
| 986-410 | 1" x 14" | Jam |

Grease Nuts



CABLE GREASE NUT

Part No. 986-500

1" x 14 Pitch Thread

Built in Grease seal with easy steer nuts, it lubricates and seals out moisture and salt water. Extends cable life the inexpensive way. Easy installation. Fits Merc, Mariner, OMC, Yamaha, Suzuki Chrysler/Force and Nissan. Anodized. (Fits Most Mercs)



CABLE GREASE NUT

Part No. 986-505

7/8" x 14 Pitch Thread

(Fits All Others)



CABLE NUT FOR CABLE SIDE

Part No. 986-510

7/8" X 14 Pitch Threads I.D. or O.D.

This nut injects oil directly onto cable.
FITS ALL OUTBOARDS

YAMAHA LOWER END GASKET KIT



Part No. 800-325

O.E. No. 6A0-W0001-21
92 C40/MHO/ERO/PRO
93 C40(MH/ER/PR)R
94 C40(MH/ER/PR)S

YAMAHA INDIVIDUAL GASKETS/SEALS

| Item # | Description | O.E. No. | Part No. |
|--------|-------------------------|--------------|----------|
| 1 | Upper Casing Gasket | 676-45114-A1 | 555-27 |
| 2 | Seal 2 | 676-45128-00 | 555-26 |
| 3 | Water Pump Gasket | 676-44315-A1 | 555-20 |
| 4 | Water Pump Gasket | 679-44316-A0 | 555-22 |
| 5 | Catridge Gasket | 676-44324-A0 | 555-21 |
| 6 | Exhaust Manifold Gasket | 676-41133-A1 | 555-23 |
| 7 | Lower Casing Packing | 677-45315-A0 | 555-11 |
| 8 | Seal 1 | 676-45127-00 | 555-25 |
| 9 | Gasket | 90430-08020 | 555-10 |
| 10 | O-Ring (132) | 93210-41042 | 527-50 |
| 11 | O-Ring (6H4) | 93210-66M98 | 527-51 |
| 12 | O-Ring (6F5) | 90430-06M03 | 555-12 |
| 13 | Oil Seal 22X36X-66 | 93101-22067 | 552-10 |

YAMAHA LOWER END GASKET KIT

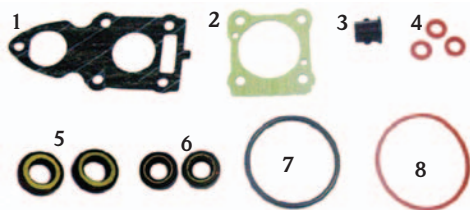

Part No. 800-327

O.E. No. 6G1-W0001-C1
97 6/8MHV
98 6MHW
99 6/8MHX
01 8MSHZ
02 8MSHA
03 8MSHB
04 8MSHC
05 8MSHD

YAMAHA INDIVIDUAL GASKETS/SEALS

| Item # | Description | O.E. No. | Part No. |
|--------|----------------------|--------------|----------|
| 1 | Lower Casing Packing | 6G1-45315-A0 | 555-30 |
| 2 | Water Pump Gasket | 6G1-44315-A0 | 555-31 |
| 3 | Water Seal 2 | 647-44366-00 | 555-32 |
| 4 | Gasket | 90430-08020 | 555-10 |
| 5 | Oil Seal (655) | 93101-15074 | 552-12 |
| 6 | Oil Seal (6G1) | 93101-11M23 | 552-11 |
| 7 | O-Ring (620) | 93210-49046 | 527-52 |
| 8 | O-Ring (50M) | 93210-53679 | 527-53 |

YAMAHA LOWER END GASKET KIT

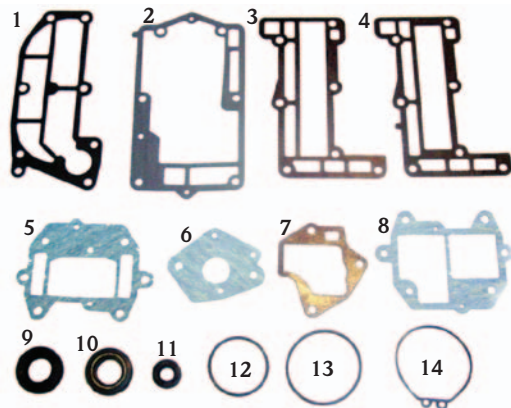

Part No. 800-330

O.E. No. 6G1-W0001-A2
96 6/8MHU

YAMAHA INDIVIDUAL GASKETS/SEALS

| Item # | Description | O.E. No. | Part No. |
|--------|-------------------------|--------------|----------|
| 1 | Head Cover 1 Gasket | 6G1-11193-A1 | 555-37 |
| 2 | Upper Casing Gasket | 6G1-45113-A1 | 555-38 |
| 3 | Exhaust Inner Gasket | 6G1-41112-A1 | 555-39 |
| 4 | Exhaust Outer Gasket | 6G1-41114-A0 | 555-40 |
| 5 | Intake Manifold Gasket | 6G1-13645-A1 | 555-33 |
| 6 | Gasket | 6G1-14198-A1 | 555-34 |
| 7 | Exhaust Manifold Gasket | 6G1-41133-A0 | 555-35 |
| 8 | Valve Seat Gasket | 6G1-13621-A1 | 555-36 |
| 9 | Oil Seal (6E0) | 93102-20M25 | 552-13 |
| 10 | Oil Seal (6J1) | 93101-20M29 | 552-50T |
| 11 | Oil Seal (6G1) | 93101-12M26 | 552-15 |
| 12 | O-Ring (647) | 93210-42159 | 527-54 |
| 13 | O-Ring (6G1) | 93210-54M54 | 527-55 |
| 14 | Float Chamber Gasket | 6G1-14984-00 | 527-56 |

YAMAHA LOWER END GASKET KIT

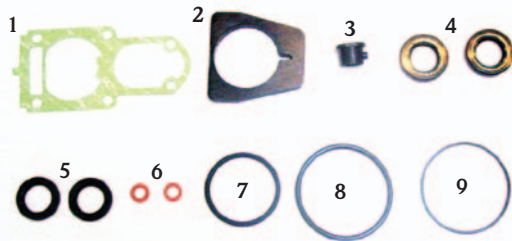

Part No. 800-331

O.E. No. 6L2-W0001-C3
 96 20MHU - 25(MH/EH/ER)U 02 25MSHA
 97 20MHV - 25(MH/EH/ER)V 03 25MSHB
 98 25MH/EH/ERW 04 25MSHC
 00 25MSHY/MLHY 05 25MSHD
 01 25MHZ

YAMAHA INDIVIDUAL GASKETS/SEALS

| Item # | Description | O.E. No. | Part No. |
|--------|-------------------------|--------------|----------|
| 1 | Lower Casing Packing | 6L2-45315-A0 | 555-55 |
| 2 | Exhaust Manifold Gasket | 6L2-41134-00 | 555-56 |
| 3 | Water Seal Damper | 6L2-44367-00 | 555-57 |
| 4 | Oil Seal | 93101-20M07 | 552-23 |
| 5 | Oil Seal | 93102-20484 | 552-22 |
| 6 | Gasket | 90430-08020 | 555-10 |
| 7 | O-Ring | 93210-45161 | 527-66 |
| 8 | O-Ring (6J8) | 93210-60MA3 | 527-67 |

YAMAHA LOWER END GASKET KIT

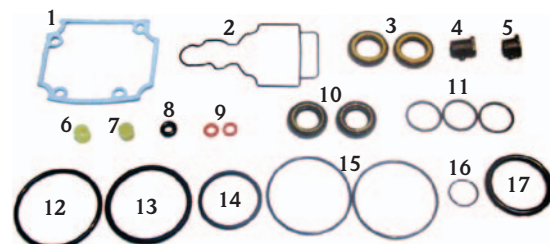

Part No. 800-333

O.E. No. 61N-W0001-E1
 96 C30ERU
 97 C30ELRV

YAMAHA INDIVIDUAL GASKETS/SEALS

| Item # | Description | O.E. No. | Part No. |
|--------|-------------------------|--------------|----------|
| 1 | Exhaust Manifold Gasket | 664-41134-A0 | 555-65 |
| 2 | Lower Casing Packing | 61N-45315-00 | 555-64 |
| 3 | Oil Seal (22X36X6-66) | 93101-22067 | 552-10 |
| 4 | Water Seal 2 | 689-44366-00 | 555-66 |
| 5 | Water Seal Damper | 6L2-44367-00 | 555-57 |
| 6 | Exhaust Manifold Gasket | 689-41135-00 | 555-68 |
| 7 | Exhaust Manifold Gasket | 6A8-41135-00 | 555-69 |
| 8 | O-Ring | 93210-06ME6 | 527-79 |
| 9 | Gasket | 90430-08020 | 555-10 |
| 10 | Oil Seal | 93101-20M07 | 552-23 |
| 11 | O-Ring | 93210-26240 | 527-76 |
| 12 | O-Ring | 93210-64ME7 | 527-73 |
| 13 | Exhaust 1 Seal | 689-41141-00 | 527-74 |
| 14 | O-Ring | 93210-45161 | 527-75 |
| 16 | O-Ring (61N) | 93210-22ME5 | 527-78 |
| 17 | Exhaust 2 Seal | 689-41142-00 | 527-100 |

YAMAHA LOWER END GASKET KIT

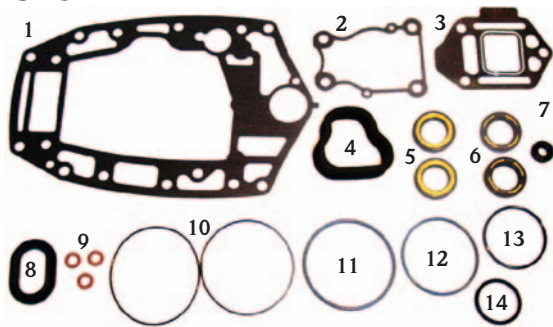

Part No. 800-334

O.E. No. 63D-W0001-20
 97 40MHV 40/50(ER/TH/TR)V 02 40/50TLRA, C40TLRA
 97 C40TRV 03 40/50TLRB
 98 C40/C50TRW 04 40/50TLRC
 98 40MH/ER/TR/P40TH/50ERW 05 40/50TLRD
 99 C40/C50TRX
 99 40(MH/ER/TR/50ER)X
 00 C40/C50TLRY
 00 40MJHY
 01 40MHZ/TRZ/TLRZ/MLHZ, 50/C40/C50TLRZ

YAMAHA INDIVIDUAL GASKETS/SEALS

| Item # | Description | O.E. No. | Part No. |
|--------|-------------------------|--------------|----------|
| 1 | Upper Casing Gasket | 63D-45114-A0 | 555-80 |
| 2 | Water Pump Gasket | 63D-44316-00 | 555-81 |
| 3 | Exhaust Manifold Gasket | 6H4-41134-A0 | 555-82 |
| 4 | Muffler Gasket | 63D-45123-00 | 555-83 |
| 5 | Oil Seal (22X36X6-66) | 93101-22067 | 552-10 |
| 6 | Oil Seal | 93101-25M57 | 552-33 |
| 7 | Oil Seal | 93106-09014 | 552-34 |
| 8 | Seal 1 | 6H3-45127-00 | 555-84 |
| 9 | Gasket | 90430-08020 | 555-10 |
| 10 | O-Ring (XEA) | 93210-74775 | 527-86 |
| 11 | O-Ring | 93210-69MG6 | 527-87 |
| 12 | O-Ring | 93210-59MG7 | 527-88 |
| 13 | O-Ring | 93210-48MG8 | 527-89 |
| 14 | O-Ring | 93210-33MG4 | 527-90 |

YAMAHA LOWER END GASKET KIT

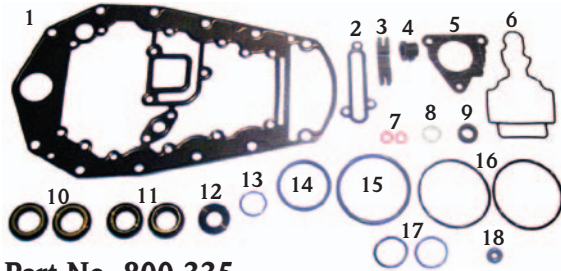

Part No. 800-335

O.E. No. 65W-W0001-20
 03 T25TLRB
 03 F25MSHB/MLHB/TLRB/ELHB/ESHB/ESRB
 04 F25MSHC/MLHC/TLRC/ELHC/ELRC/ESHC/ESRC

YAMAHA INDIVIDUAL GASKETS/SEALS

| Item # | Description | O.E. No. | Part No. |
|--------|-------------------------|--------------|----------|
| 1 | Oil Pan Gasket | 62Y-15312-00 | 555-89 |
| 2 | Gasket | 62Y-13475-00 | 555-90 |
| 3 | Seal 2 | 65W-45128-00 | 555-93 |
| 4 | Water Seal Damper | 6L2-44367-00 | 555-57 |
| 5 | Exhaust Manifold Gasket | 62Y-41133-00 | 555-122 |
| 6 | Lower Casing Packing | 61N-45315-00 | 555-64 |
| 7 | Gasket | 90430-08020 | 555-10 |
| 8 | Gasket | 90430-14M09 | 555-91 |
| 9 | Gasket | 90430-12072 | 555-92 |
| 10 | Oil Seal 22X36X-66 | 93101-22067 | 552-10 |
| 11 | Oil Seal | 93101-20M07 | 552-23 |
| 12 | Oil Seal | 93104-16M01 | 552-39 |
| 13 | O-Ring | 93210-22298 | 527-103 |
| 14 | O-Ring | 93210-45161 | 527-66 |
| 15 | O-Ring | 93210-64ME7 | 527-73 |
| 16 | O-Ring | 93210-65M50 | 527-107 |
| 17 | O-Ring | 93210-26240 | 527-76 |
| 18 | O-Ring | 93210-06ME6 | 527-79 |

YAMAHA LOWER END GASKET KIT

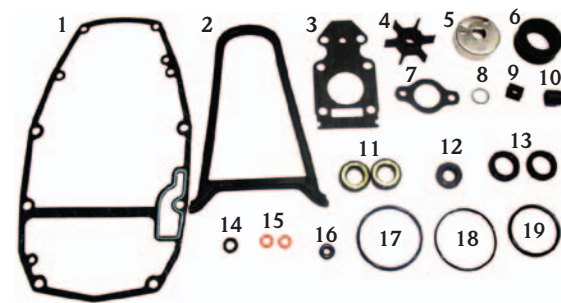

Part No. 800-336

O.E. No. 66M-W0001-20
 98 F15MH/EHW
 99 F15MSHX/ESHX/MLHX/ELHX
 00 F15MSHY/MLHY/ELHY/ESHY/ELHY
 01 F15PLHZ/PLRZ/MH/EHZ
 02 F15(MSH/MLH/ESH/ELH/PLR/PLH)A
 03 F15(MSH/MLH/ESH/ELH/PLR/PLH)B
 04 F15(MSH/MLH/ESH/ELH/PLR/PLH)C

YAMAHA INDIVIDUAL GASKETS/SEALS

| Item # | Description | O.E. No. | Part No. |
|--------|-------------------------|--------------|----------|
| 1 | Upper Casing Gasket | 66M-45113-00 | 555-99 |
| 2 | Upper Casing Gasket | 66M-45115-00 | 555-100 |
| 3 | Lower Casing Packing | 63V-45315-A0 | 555-101 |
| 4 | Impeller | 63V-44352-01 | 555-102 |
| 5 | Cartridge Insert | 63V-44322-00 | 555-103 |
| 6 | Ext. 1 Seal | 66M-41138-00 | 555-104 |
| 7 | Exhaust Manifold Gasket | 66M-41138-00 | 555-105 |
| 8 | Gasket | 90430-14M09 | 555-91 |
| 9 | Water Seal | 63V-44365-10 | 555-107 |
| 10 | Water Seal 4 Rubber | 63V-44368-00 | 555-108 |
| 11 | Oil Seal (17X30X6-65) | 93101-17054 | 552-42 |
| 12 | Oil Seal (6G8) | 93101-13M27 | 552-43 |
| 13 | Oil Seal | 93102-20484 | 552-22 |
| 14 | Seal 2 | 66M-45128-00 | 555-86 |
| 15 | Gasket | 90430-08020 | 555-10 |
| 16 | O-Ring | 93210-06ME6 | 527-79 |
| 17 | O-Ring (683) | 93210-57M09 | 527-115 |
| 18 | O-Ring (6J8) | 93210-56M08 | 527-116 |
| 19 | O-Ring (55X) | 93210-44704 | 527-1 |

YAMAHA LOWER END GASKET KIT

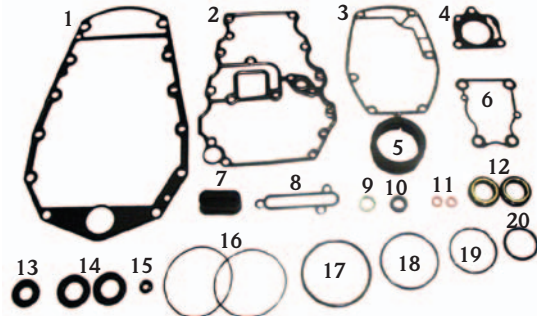

Part No. 800-337

O.E. No. 67C-W0001-20
 00 F40(ESR/MSH/MLH/TLR)Y
 01 T25TLAZ
 01 F30TRZ/F40ERZ/MHZ/TRZ

YAMAHA INDIVIDUAL GASKETS/SEALS

| Item # | Description | O.E. No. | Part No. |
|--------|-------------------------|--------------|----------|
| 1 | Upper Casing Gasket | 67C-45113-00 | 555-112 |
| 2 | Oil Pan Gasket | 67C-15312-00 | 555-113 |
| 3 | Exhaust Manifold Gasket | 62Y-41134-01 | 555-114 |
| 4 | Exhaust Manifold Gasket | 62Y-41133-01 | 555-115 |
| 5 | Muffler Gasket | 67C-45123-00 | 555-116 |
| 6 | Water Pump Gasket | 63D-44316-00 | 555-81 |
| 7 | Seal | 67Y-45127-00 | 555-118 |
| 8 | Gasket | 67Y-13475-00 | 555-90 |
| 9 | Gasket | 90430-14M09 | 555-91 |
| 10 | Gasket | 90430-12072 | 555-92 |
| 11 | Gasket | 90430-08020 | 555-10 |
| 12 | Oil Seal (22X36X6-66) | 93101-22067 | 552-10 |
| 13 | Oil Seal | 93104-20484 | 552-22 |
| 14 | Oil Seal | 93101-22M60 | 552-48 |
| 15 | O-Ring | 93210-06ME6 | 527-79 |
| 16 | O-Ring (XEA) | 93210-74775 | 527-86 |
| 17 | O-Ring | 93210-69MG6 | 527-87 |
| 18 | O-Ring | 93210-58MG7 | 527-125 |
| 19 | O-Ring | 93210-48MG8 | 527-89 |
| 20 | O-Ring | 93210-33MG4 | 527-90 |

I/O

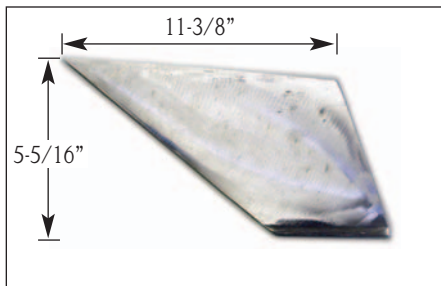

Alpha
I New Generation (Swept Back)
Part No. SK26

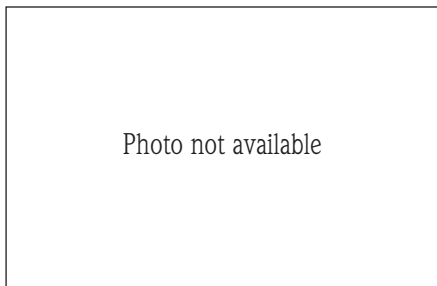

OMC
Cobra 1994 & Later (Thick Style)
Part No. SK29

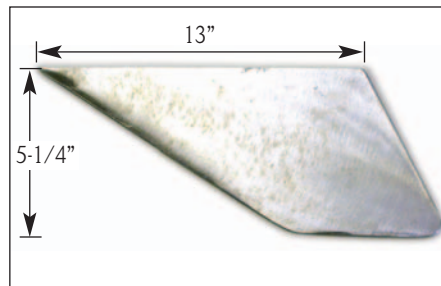

OMC
COBRA V-6 (Prior to 1994 thin style)
Part No. SK9

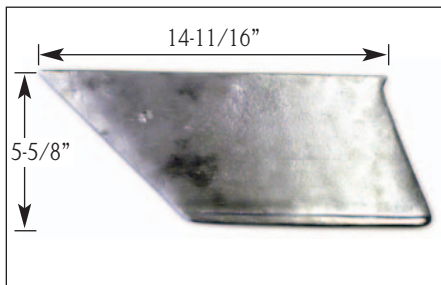

OMC
King Cobra
Part No. SK24

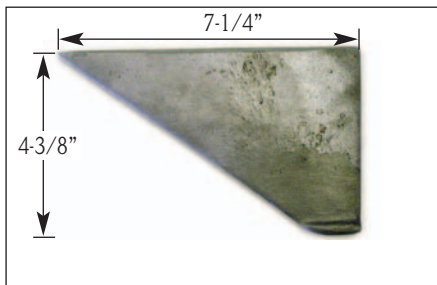

OMC
Model 14
Part No. SK22

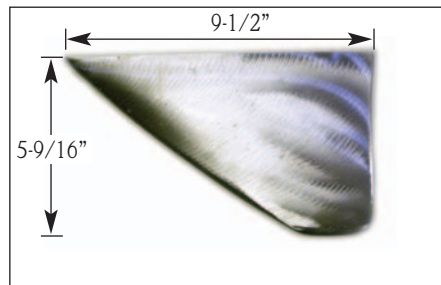

Mercury
I (Straight Back)
Part No. SK3



Mercury
(Swept Back)
Part No. SK4

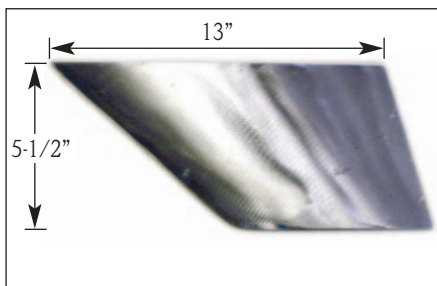

Mercury
Bravo
Part No. SK14

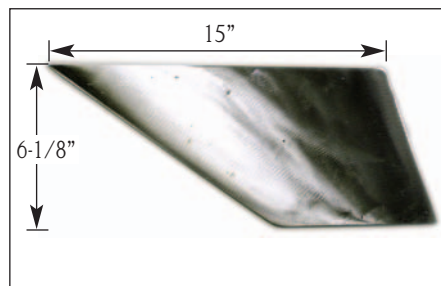

Mercury
Bravo 1990 & Later
Part No. SK28

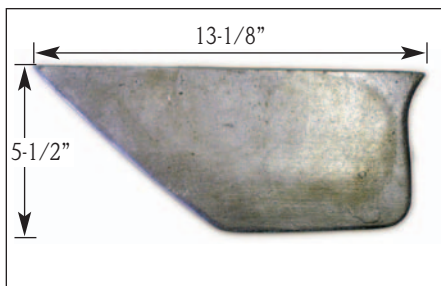

Mercury
TR 215, Mercruiser III TRS
Part No. SK11

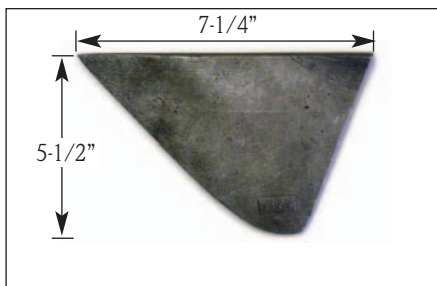

Volvo
270-290
Part No. SK15

Outboard

LOWER END

2008 OUTBOARD ENGINE PARTS

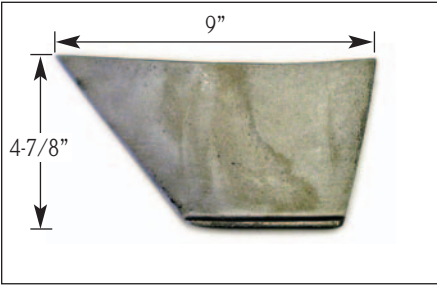

Chrysler
75-115 H.P.
Part No. SK12

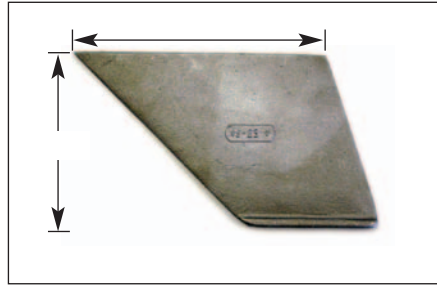

Force
125 New Style (Swept Back)
Part No. SK23

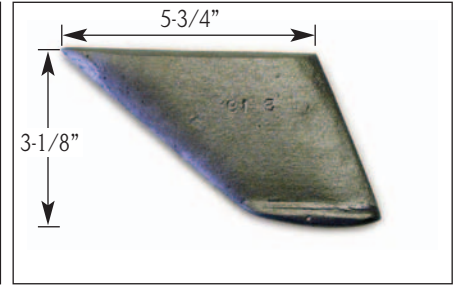

Mercury
9.9 H.P.
Part No. SK19

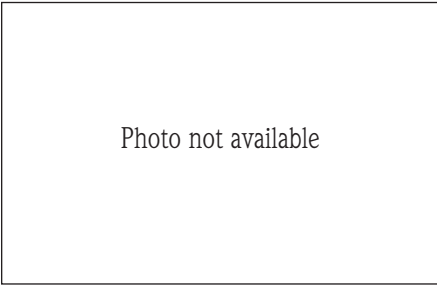

Mercury
20 H.P.
Part No. SK1

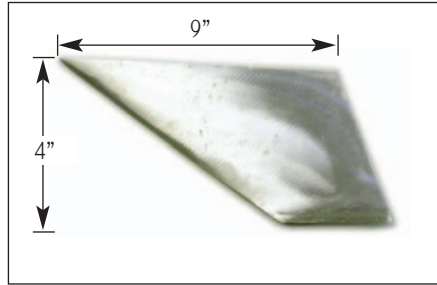

Mercury
40-70 H.P. (Swept Back)
Part No. SK16

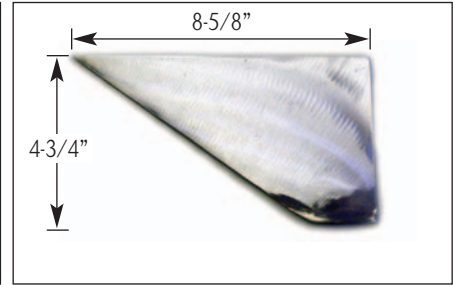

Mercury
40-70 H.P. (Straight Back)
Part No. SK2

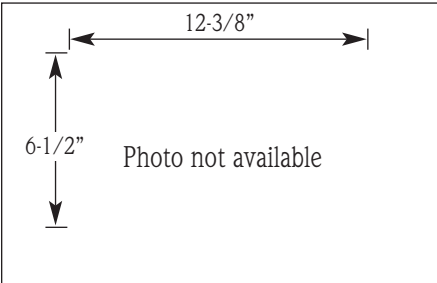

Mercury
V-6 and Black Max
Part No. SK4

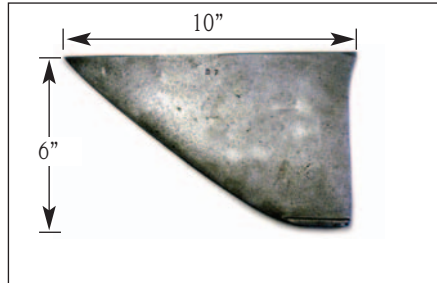

Mercury
Full bullet Modified S-3 (Straight Back)
Part No. SK27

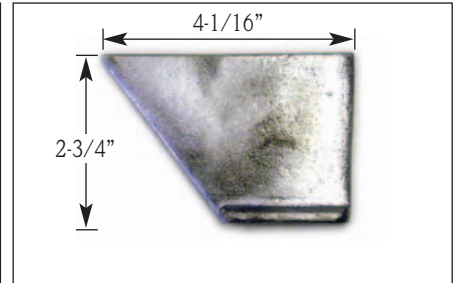

OMC
9.9, 15 H.P.
Part No. SK21

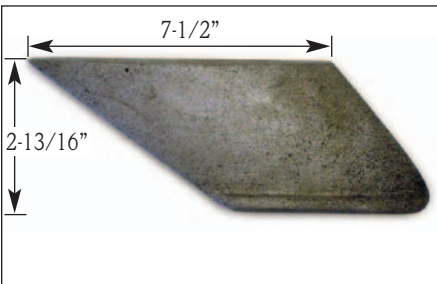

OMC
25-35 H.P.
Part No. SK18

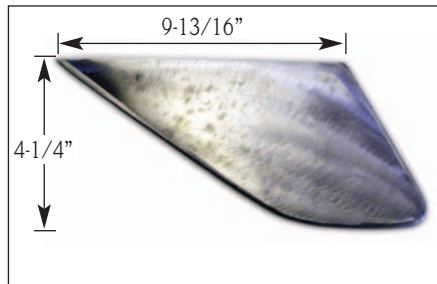

OMC
50-70 H.P. (Swept Back)
Part No. SK5

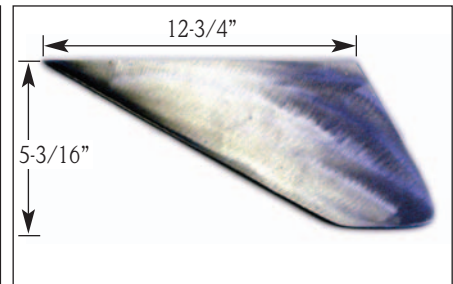

OMC
V-4 (Swept Back)
Part No. SK6

Outboard

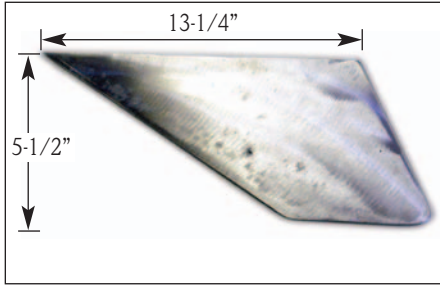

OMC
V-6 (Older Style)
Part No. SK7

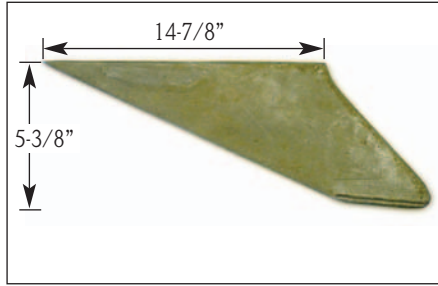

OMC
275 V-8
Part No. SK10

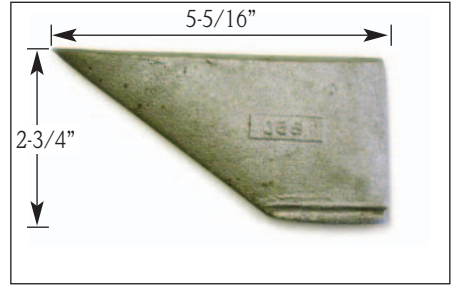

Suzuki
9.9, 15 H.P.
Part No. SK20

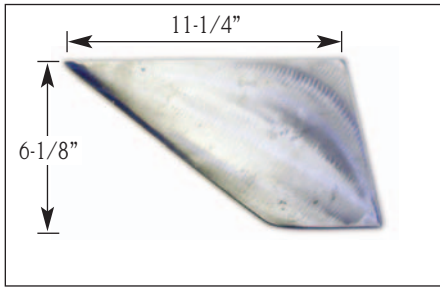

Suzuki
150 H.P. & up (Swept Back)
Part No. SK25

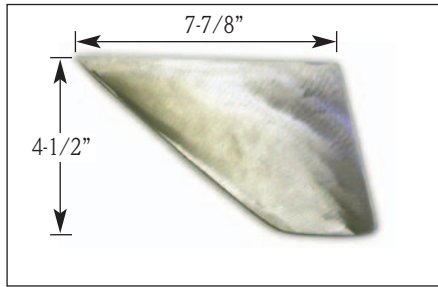

Yamaha
50 H.P. (Swept Back)
Part No. SK17

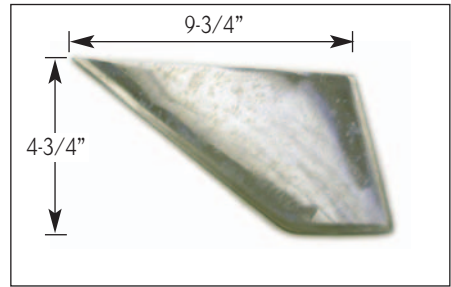

Yamaha
70-90 H.P.
Part No. Y79-88

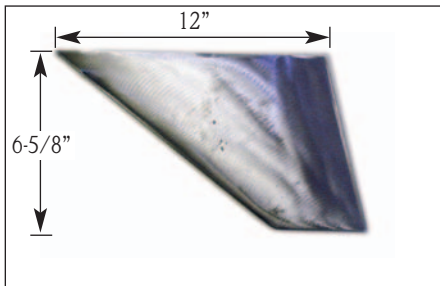

Yamaha
V-6
Part No. SK8





Chrysler 50
Part No. CP6



Mercuriser
1-Round Back (left Side)
Part No. CP1L

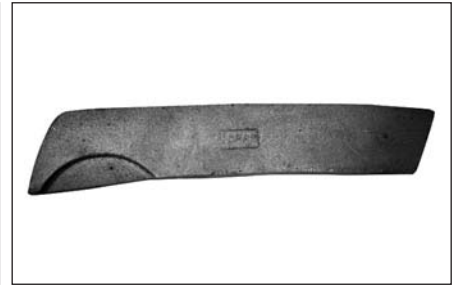

Mercuriser
1-Round Back (Right Side)
Part No. CP1R

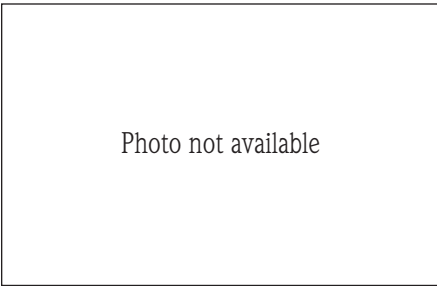

Mercury
V-6, Large Square Back (left Side)
Part No. CP2L

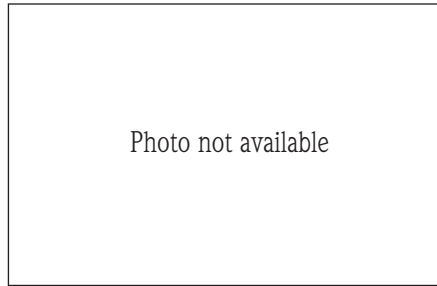

Mercury
V-6, Large Square Back (Right Side)
Part No. CP2R



Mercury
Inline 6, Small Sq. Back (left Side)
Part No. CP5L

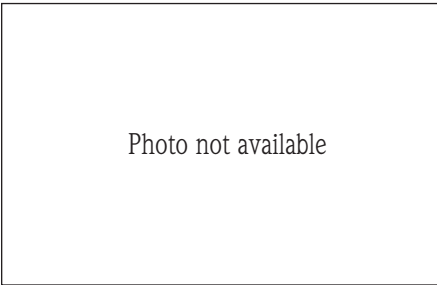

Mercury
Inline 6, Small Sq. Back (Right side)
Part No. CP5R

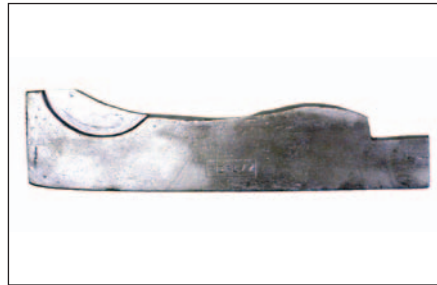

Mercury Bravo
I/O (left Side)
Part No. CP7L

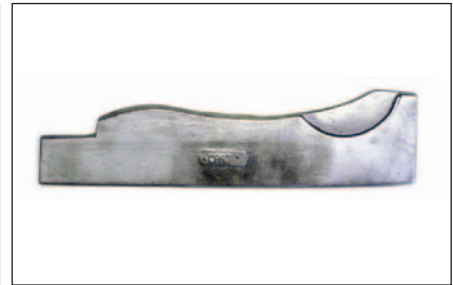

Mercury Bravo
I/O (Right Side)
Part No. CP7R



Mercury
40-70 (Left side)
Part No. CP11L



Mercury
40-70 (Right side)
Part No. CP11R

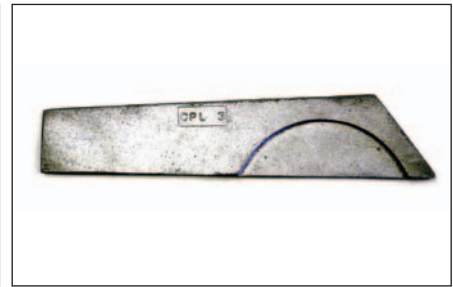

OMC
V-4 (left Side)
Part No. CP3L

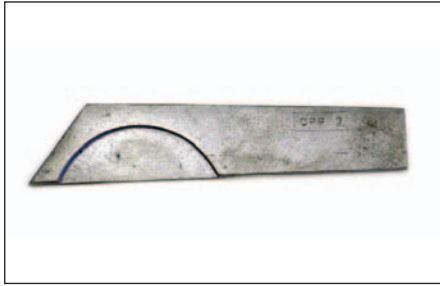

OMC
V-4 (Right Side)
Part No. CP3R

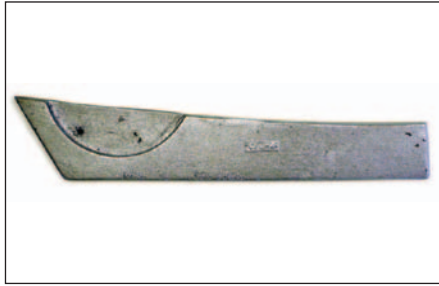

OMC
V-6 (Left side)
Part No. CP4L



OMC
V-6 (Right Side)
Part No. CP4R



Volvo
270-290 (Left side)
Part No. CP8L



Volvo
270-290 (Right Side)
Part No. CP8R

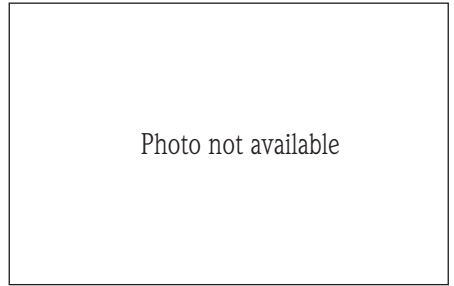

Yamaha
V-6, 150-225 (Left side)
Part No. CP9L

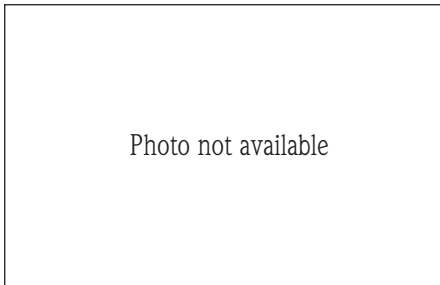

Yamaha
V-6, 150-225 (Right side)
Part No. CP9R



Yamaha
50 (Left side) (Left side)
Part No. CP10L



Yamaha
50 (Right side)
Part No. CP10R